

dholera
— GREENFIELD SMART CITY —

ZONE - Tourism: Resort,
Recreation, Solar Park

DHOLERA SIR

TALUKA - DHOLERA
VILLAGE - GOGLA
SURVEY NO. - 293

9,000 sq ft
(50 x 180)

For More Details Call 7999717347



HARSH VINAYAK
REAL ESTATE

Call 7999717347

www.harshvinayak.com
Marketed by Harsh Vinayak Real Estate

LEGEND

	DSIRDA BOUNDARY
	T P SCHEME BOUNDARY
	GAMTAL
	RIVER / CANAL
	TALAV / LAKE
	DP PROPOSED ROADS
	T P SCHEME ROADS
	COASTAL REGULATION ZONE
	GREEN SPACE
	RECREATION, SPORTS AND ENTERTAINMENT ZONE
	TOURISM: RESORTS
	VILLAGE BUFFER
	AGRICULTURE ZONE
	STRATEGIC INFRASTRUCTURE ZONE
	CITY CENTRE
	LOGISTICS
	HIGH ACCESS CORRIDOR
	RESIDENTIAL ZONE
	SOLAR PARK
	PUBLIC FACILITIES ZONE
	KNOWLEDGE AND I.T. ZONE
	INDUSTRIAL ZONE



**Plot
Location**

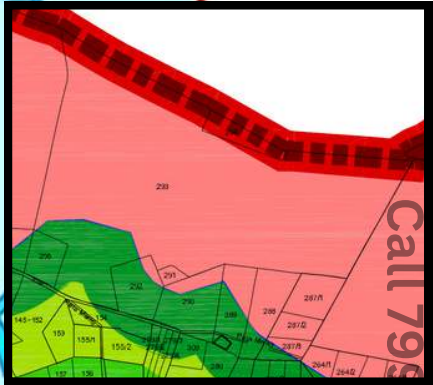

**Village - Gogla
Survey No. 293**

www.harshvinayak.com

For More Details Call 7999717347

Marketed by Harsh Vinayak Real Estate

PRODUCED BY AN AUTODESK EDUCATIONAL PRODUCT

DHOLERA SPECIAL INVESTMENT REGIONAL DEVELOPMENT AUTHORITY (DSIRDA)

UDYOG BHAVAN, BLOCK NO.11-12, 3RD FLOOR, SECTOR-11, GANDHINAGAR (382017)
PHONE: (079) 23240150-52-54, FAX: (079) 23248443, WEBSITE: www.dholerasir.com

PART PLAN OF SANCTIONED DEVELOPMENT PLAN

Draft Development Plan is sanctioned by Apex Authority (GIDB) vide Notification No.SIRAA/01/2012/525 Dated 10.09.2012
U/s 17 (2) of GSIR Act, 2009 and U/s 17 (1) of GTP & UD Act, 1976

Details of Survey No.

Taluka :- Dholera
Village :- Gogla
Survey No :- 293

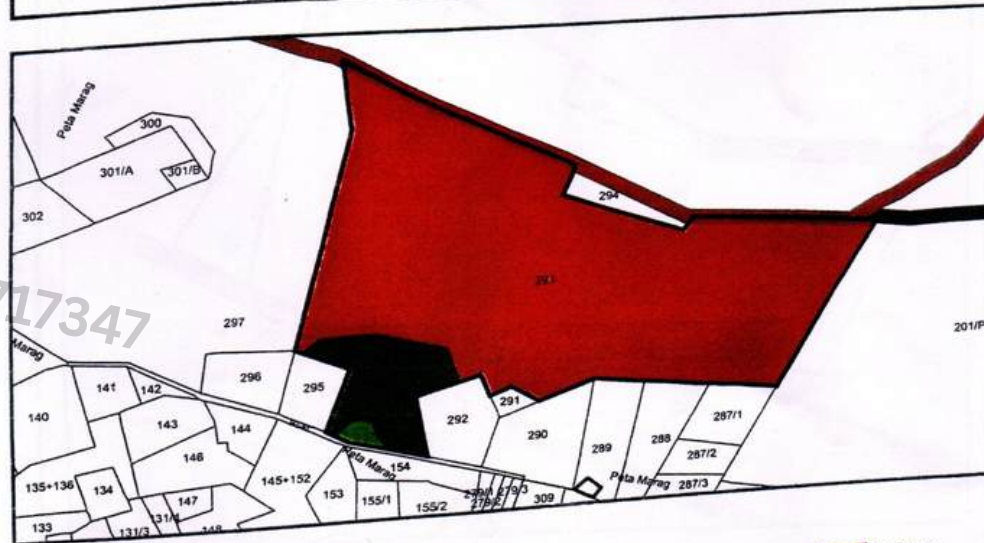

LEGEND

- | | | |
|------------------------|------------------------------------|------------------------|
| TALUKA BOUNDARY | RIVER / CANAL | RESIDENTIAL |
| DSIRDA BOUNDARY | TANK / LAKE | SOLAR PARK |
| VILLAGE BOUNDARY | COASTAL REGULATION ZONE | PUBLIC FACILITIES ZONE |
| EXISTING STATE HIGHWAY | GREEN SPACE | KNOWLEDGE AND IT |
| EXISTING ROADS | RECREATION, SPORTS & ENTERTAINMENT | INDUSTRIAL |
| GANTAL | TOURISM: RESORTS | |
| SURVEY NUMBER BOUNDARY | VILLAGE BUFFER | |
| | AGRICULTURE | |
| | STRATEGIC INFRASTRUCTURE | |
| | CITY CENTRE | |
| | LOGISTICS | |
| | HIGH ACCESS CORRIDOR | |
| | PROPOSED ROADS | |

Final plot boundary and allotment of final plot as subject to variation. This part Plan can not be used for making any entry in revenue records.
Final plot boundary and allotment of final plot as subject to variation. This part Plan can not be used for making any entry in revenue records.
No part of this document plan may be reproduced without prior written permission given by DSIRDA, Gandhinagar.

Prepared & Checked By:

[Signature]

Date: 25/08/2025



OWN PLANNER
DSIRDA, GANDHINAGAR



www.harshvinayak.com
For More Details Call 7999717347

Marketed by Harsh Vinayak Real Estate

Call 7999717347

PRODUCED BY AN AUTODESK EDUCATIONAL PRODUCT

DHOLERA SPECIAL INVESTMENT REGIONAL DEVELOPMENT AUTHORITY (DSIRDA)

UDYOG BHAVAN, BLOCK NO. 11-12, 3RD FLOOR, SECTOR-11, GANDHINAGAR (382017)
PHONE: (079) 23240150-52-54, FAX: (079) 23248443, WEBSITE: www.dholerasir.com

PART PLAN OF SANCTIONED DRAFT TOWN PLANNING SCHEME NO. 1

Draft TPS NO -1 Sanctioned by Apex Authority vide Notification No. SIRAA /03/2012/566-A dated 03 October, 2012
U/s 6(2) (iv) & 17 (2) of GSIR Act, 2009 and U/s 48 (2) of GTP & UD Act, 1976. It may be changed by TPO/Apex Authority (SIDB)



Taluka :-	Dholera
Village :-	Gogla
DTPS No. :-	1
Survey No. :-	293
OP No. :-	1283
FP No. :-	1283

LEGEND:-

O.P.NO & BOUNDARY	[Symbol]
F.P.NO & BOUNDARY	[Symbol]
PROPOSED D.D.P / D.T.P ROAD	[Symbol]
TALAV / RIVER / WATER BODY	[Symbol]
D.T.P.S. BOUNDARY	[Symbol]
VILLAGE BOUNDARY	[Symbol]



Prepared & Checked By

Date



PRODUCED BY AN AUTODESK EDUCATIONAL PRODUCT

PRODUCED BY AN AUTODESK EDUCATIONAL PRODUCT

Call 7999717347